

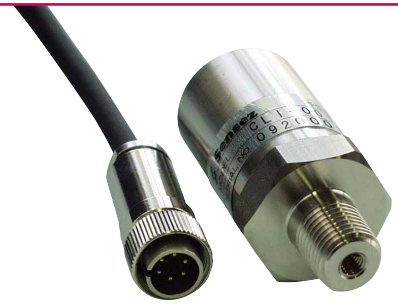

CLV • CLI

Features 1.Connector type 2.Welded structure

- Connector type of the "HL series" pressure sensor with a welded structure
- Easy to handle and highly maintainable
- Support of a wide range of pressure media such as gas and medicinal solution
- Output signal of 1 to 5 VDC or 4 to 20 mADC from a built-in amplifier circuit



Specifications

Model	CLV • CLI									
	N-100KP	-020KP	-050KP	-100KP	-300KP	-500KP	-001MP	-002MP	-003MP	-005MP
Rated pressure ※ 1	0 to -100kPa	0 to 20kPa	0 to 50kPa	0 to 100kPa	0 to 300kPa	0 to 500kPa	0 to 1MPa	0 to 2MPa	0 to 3MPa	0 to 5MPa
Pressure type	Gauge pressure ※ 2								Shield gauge pressure	
Overpressure	CLV : 200% of the rated pressure / CLI : 150% of the rated pressure									
Wetted part material	Diaphragm : SUS316L Pressure port : SUS316									
Sealing liquid	Silicone oil									
Applicable media	Gas and fluid (media not damaging the wetted part material)									
Power supply	12 to 28VDC									
Output	CLV : 1 to 5VDC / CLI : 4 to 20mADC									
Current consumption	CLV : 6mA or less									
Load resistance	CLV : 1k Ω or more / CLI : 600 Ω or less (at power of 24 VDC)									
Responsiveness	5msec or less									
Accuracy (linearity)	± 0.5% F.S. or less ※ 3 (± 0.3% F.S. or less)									
Temperature characteristics	± 0.05% F.S. / °C or less (0 to 60°C)									
Compensated temperature range	0 to 60°C									
Operating temperature range (Measurement medium temperature)	- 20 to 80°C (no freezing allowed) - 20 to 100°C (no freezing allowed)									
Operating humidity range	35 to 85% RH (no dew condensation allowed)									
Pressure connection port	R1/4 (standard) · R3/8 · R1/2 · G1/4 · G3/8									
Cable	φ6 vinyl : (with connector) 2000mm (standard) Shield cable + atmospheric relief pipe (Excluding -003MP and -005MP)									
Structure	IP66									
Insulation resistance	100M Ω or more / 500VDC									
Withstand voltage	500VAC, 1 minute									
Vibration resistance	98.1m / s ² , 2 hours (X, Y, and Z directions)									
Weight	Approx 260g									
Impact of mounting orientation (port orientation changed from downward to sideways)	+ 0.1% F.S.	+ 0.5% F.S.	+ 0.3% F.S.	+ 0.1% F.S.						

※ 1.We also manufacture compound pressure sensors (gauge pressure of 500 kPa or less).

※ 2.Make sure that the operating vacuum pressure is 10 kPa abs or more. (Operating temperature range: 0 - 60°C)

※ 3.We also manufacture high-accuracy pressure sensors (accuracy: ± 0.25% F.S. or less).

Dimensions (Units : mm)

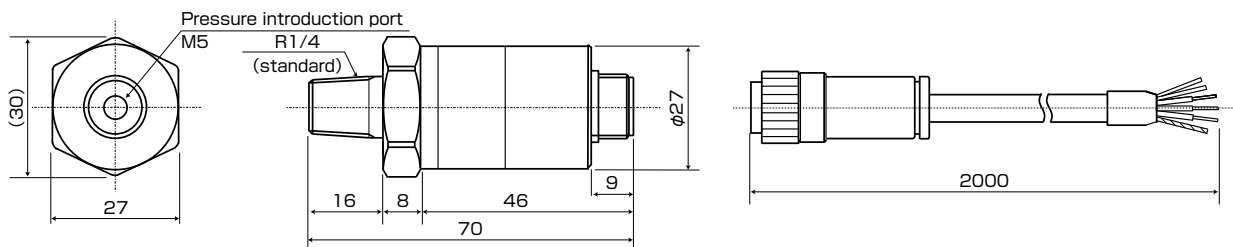

Cables / wires

	CLV	CLI
Red	Power supply +	Power supply +
White	Output	Power supply -
Black	Common	—
Atmospheric relief pipe	Gauge pressure available	

Model

C	L	I	C	-	300	KP	-	02	-	R3
Type	Output mode	Pressure range	Unit of pressure	Cable length	Pressure connection port					
V : Voltage	Special	KP : kPa	02 : 2m (standard)	Space : R1/4 (standard)						
I : Current	Space : Positive pressure	MP : MPa	05 : 5m	R3 : R3/8						
	N : Negative pressure		10 : 10m	R4 : R1/2						
	C : Compound pressure			G2 : G1/4						
				G3 : G3/8						