



JW-7000

Features

- 1. Waterproof connector type
- 2. For gauge pressure/For absolute pressure

- Waterproof IP67 structure that is also suitable for outdoor use
- Compact pressure sensor with a stainless steel diaphragm structure
- Easy-to-handle waterproof connector type
- Output signal of 1 to 5 VDC or 4 to 20 mADC from a built-in amplifier circuit



Specifications

Model	JW-7300 / JW-7200							
	-020KP	-050KP	-100KP	-300KP	-500KP	-600KP	-001MP	-002MP
Rated pressure ※ 1	0 to 20kPa	0 to 50kPa	0 to 100kPa	0 to 300kPa	0 to 500kPa	0 to 600kPa	0 to 1MPa	0 to 2MPa
Pressure type ※ 2	Gauge pressure					Gauge pressure		
	Absolute pressure					Absolute pressure		
Overpressure	JW-7300 : 200% of the rated pressure / JW-7200 : 150% of the rated pressure							
Wetted part material	Diaphragm : SUS316L Pressure port : SUS316 O-ring : Fluororubber							
Sealing liquid	Silicone oil							
Applicable media	Gas and fluid (media not damaging the wetted part material)							
Power supply	12 to 28VDC							
Output	JW-7300 : 1 to 5VDC / JW-7200 : 4 to 20mADC ※ 3							
Current consumption	JW-7300 : 6mA or less							
Load resistance	JW-7300 : 1k Ω or more / JW-7200 : 600 Ω or less (at power of 24 VDC)							
Responsiveness	5msec or less							
Accuracy (linearity)	± 0.5% F.S. or less ※ 4 (± 0.3% F.S. or less)							
Temperature characteristics	± 0.05% F.S. /°C or less (0 to 60°C)							
Compensated temperature range	0 to 60°C							
Operating temperature range	- 10 to 80°C (no freezing allowed)							
Operating humidity range	35 to 85% RH (no dew condensation allowed)							
Pressure connection port	R1/4 (standard) · R3/8 · G3/8							
Cable	φ 6 vinyl (with connector) : 2000mm (standard) Shield + atmospheric relief pipe (Gauge pressure)							
Structure	IP67							
Insulation resistance	100M Ω or more / 500VDC							
Withstand voltage	500VAC, 1 minute							
Vibration resistance	98.1m/s ² , 2 hours (X, Y, and Z directions)							
Weight	Approx 220g							
Impact of mounting orientation (port orientation changed from downward to sideways)	+ 0.5% F.S.	+ 0.3% F.S.	+ 0.1% F.S.					

※ 1. We also manufacture negative pressure and compound pressure sensors (gauge pressure of 500 kPa or less).

※ 2. In the case of gauge pressure, make sure that the operating vacuum pressure is 10 kPa abs or more. (Operating temperature range: 0 - 60°C)

※ 3. For the pressure range of 50 kPa abs, we can manufacture sensors only with a voltage output of 1 to 5 VDC. (Overpressure: 100 kPa abs)

※ 4. We also manufacture high-accuracy pressure sensors (accuracy: ± 0.25% F.S. or less).

Dimensions (Units : mm)

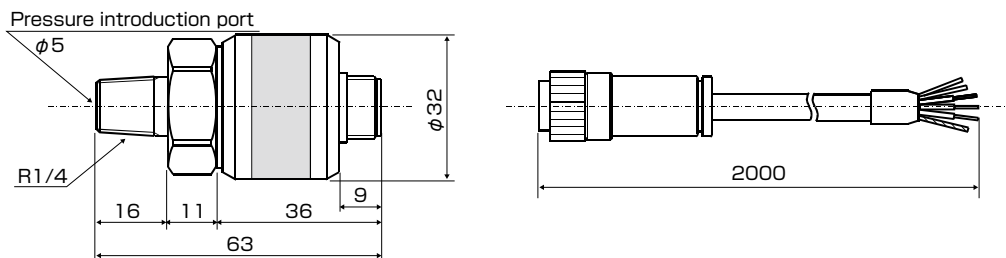

Cables / wires

	JW-7300	JW-7200
Red	Power supply +	Power supply +
White	Output	Power supply -
Black	Common	—
Atmospheric relief pipe	Gauge pressure available	

Model

Output mode	Pressure type	Special	Unit of pressure	Cable length	O-ring	Pressure connection port
1 : Element	0 : Positive pressure	0 : None	02 : 2m	V : Fluororubber	Space : R1/4 (standard)	
2 : Current 4-20mA	1 : Negative pressure	1 to 9 : Special	05 : 5m	N : NBR	G3 : G3/8	
3 : Voltage 1-5V	2 : Compound pressure (Accuracy / Output / unit etc.)		10 : 10m	X : Other	R3 : R3/8	
4 : Voltage 1-2V / 6-12V	3 : Absolute pressure					