



## JW-6000



### Features 1. Waterproof connector type 2. Welded structure

- Compact pressure sensor with a stainless steel diaphragm structure
- Outdoor specification / Waterproof IP67 structure
- Welded structure type that does not use an O-ring in the wetted part; wetted part made of SUS316 or SUS316L that has high corrosion resistance to support a wide range of pressure media such as water, oil, and gas
- Easy-to-handle waterproof connector type
- A wide range of absolute and gauge pressures from 20 kPa to 5 MPa
- Output signal of 1 to 5 VDC or 4 to 20 mADC from a built-in amplifier circuit

### Specifications

Model	JW-6300 / JW-6200									
	-020KP	-050KP	-100KP	-300KP	-500KP	-600KP	-001MP	-002MP	-003MP	-005MP
Rated pressure ※ 1	0 to 20kPa	0 to 50kPa	0 to 100kPa	0 to 300kPa	0 to 500kPa	0 to 600kPa	0 to 1MPa	0 to 2MPa	0 to 3MPa	0 to 5MPa
Pressure type ※ 2	Gauge pressure	Gauge pressure / Absolute pressure			Gauge pressure	Absolute pressure	Gauge pressure		Shield gauge pressure	
Overpressure	JW-6300 : 200% of the rated pressure / JW-6200 : 150% of the rated pressure									
Wetted part material	Diaphragm : SUS316L Pressure port : SUS316									
Sealing liquid	Silicone oil									
Applicable media	Gas and fluid (media not damaging the wetted part material)									
Power supply	12 to 28VDC									
Output	JW-6300 : 1 to 5VDC / JW-6200 : 4 to 20mADC ※ 3									
Load resistance	JW-6300 : 1k Ω or more / JW-6200 : 600 Ω or less (at power of 24 VDC)									
Responsiveness	5msec or less									
Accuracy (linearity)	± 0.5% F.S. or less ※ 4 (± 0.3% F.S. or less)									
Temperature characteristics	± 0.05% F.S. / °C or less (0 to 60°C)									
Compensated temperature range	0 to 60°C									
Operating temperature range (Measurement medium temperature)	- 20 to 80°C (no freezing allowed) - 20 to 100°C (no freezing allowed)									
Operating humidity range	35 to 85% RH (no dew condensation allowed)									
Pressure connection port	R1/4 (standard) · R3/8 · R1/2 · G1/4 · G3/8									
Cable	φ 6 vinyl (with connector) : 2000mm (standard) Shield + (Gauge pressure : atmospheric relief pipe)									
Wire outlet	G1/2 Applicable outer cable diameter : φ 6.5 to 8.0									
Structure	IP67									
Insulation resistance	100M Ω or more / 500VDC									
Withstand voltage	500VAC, 1 minute									
Vibration resistance	98.1m / s <sup>2</sup> , 2 hours (X, Y, and Z directions)									
Weight	Approx 270g									
Impact of mounting orientation (port orientation changed from downward to sideways)	+ 0.5% F.S.	+ 0.3% F.S.	+ 0.1% F.S.							

※ 1. We also manufacture negative pressure and compound pressure sensors (gauge pressure of 500 kPa or less).

※ 2. In the case of gauge pressure, make sure that the operating vacuum pressure is 10 kPa abs or more. (Operating temperature range: 0 - 60°C)

※ 3. For the pressure range of 50 kPa abs, we can manufacture sensors only with a voltage output of 1 to 5 VDC. (Overpressure: 100 kPa abs)

※ 4. We also manufacture high-accuracy pressure sensors (accuracy: ± 0.25% F.S. or less).

### Dimensions (Units : mm)

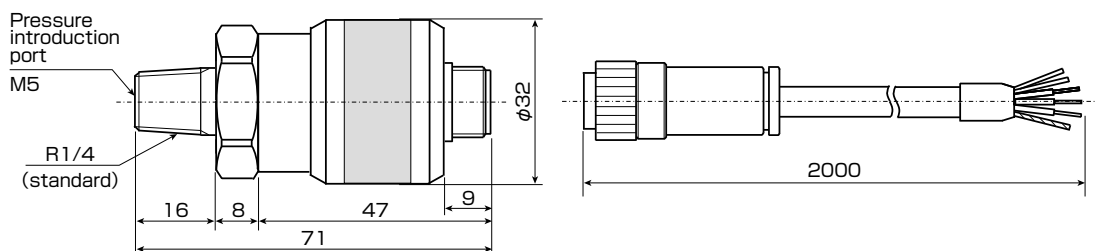

### Cables / wires

	JW-6300	JW-6200
Red	Power supply +	Power supply +
White	Output	Power supply -
Black	Common	—
Atmospheric relief pipe	Gauge pressure available	

### Model



Output mode	Pressure type	Special	Unit of pressure	Cable length	Pressure connection port
<b>1</b> : Element	<b>0</b> : Positive pressure	<b>0</b> : None		<b>02</b> : 2m	<b>Space</b> : R1/4 (standard)
<b>2</b> : Current 4 - 20mA	<b>1</b> : Negative pressure	<b>1 to 9</b> : Special (Accuracy / Output / unit etc.)		<b>05</b> : 5m	<b>R3</b> : R3/8
<b>3</b> : Voltage 1 - 5V	<b>2</b> : Compound pressure			<b>10</b> : 10m	<b>R4</b> : R1/2
<b>4</b> : Voltage 1 - 2V / 6 - 12V	<b>3</b> : Absolute pressure				<b>G2</b> : G1/4
					<b>G3</b> : G3/8